

DIN Type Connector for 1/2" Coaxial Cable

CN-Dx-CF12-4G

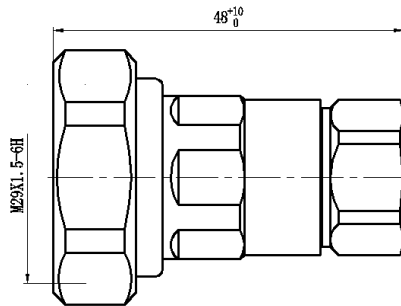

Male

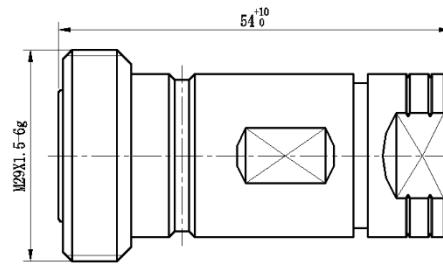

Female

Specifications

Electrical	
Nominal Impedance - [Ω]	50
Operating Frequency - [GHz]	DC-4
Center Contact Resistance - [$m\Omega$]	≤ 0.4
Outer Contact Resistance - [$m\Omega$]	≤ 1.5
Insulation Resistance - [$M\Omega$]	≥ 10000
Withstanding Voltage	≥ 4000 V RMS, 50Hz, at sea level
Insertion Loss - [dB]	$\leq 0.05 \sqrt{f}$ (GHz)
VSWR	≤ 1.15
3rd Order Inter-modulation (PIM3) - [dBc] (@2x43dBm Carriers)	≤ -160

Mechanical	
Interface Durability, Number of Cycles	500
Connector Type	DIN Male/DIN Female
Body Material	Brass, Tri-Alloy Plated
Center Contuctor Material	Tin Phosphor Bronze, Ag Plated
Insulator Material	PTFE
Other Material	Brass, Ni Plated

Environmental	
Operating Temperature - [$^{\circ}\text{C}$]	-40 ~ +85
IP Rating	IP67
RoHS	Compliant

Product Order Information

Model	ERP Code
CN-DM-CF12-4G	130306-000TBD-16
CN-DF-CF12-4G	130306-000TBD-16

*The product appearance and dimension is subject to change without prior notice.